

INDUSTRIAL AMPLIFIER CL 100P

- high accuracy
- protected IP65
- high durability
- operating temperature $-25 \div 65^{\circ}\text{C}$
- supply voltage 230 V AC
- automatic compensation of cable length influence
- three year warranty

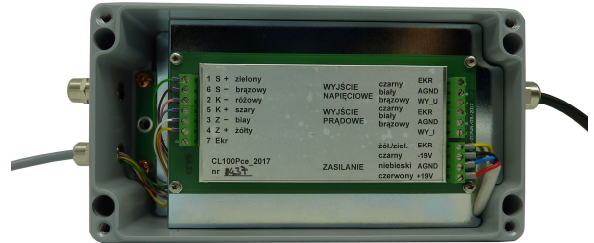

The CL 100P amplifier is designed for use with strain gauge sensors with $120 \div 1200 \Omega$ full bridge. It is especially suitable for applications in a difficult climatic and mechanical environment. This amplifier is assigned for industrial use and other environments demanding high protection against dust, vibrations and humidity.



Parameters

Type		CL 100P
Gain*	V/V	50÷1000
Transfer band	Hz	200
Supply voltage	V	5 or 10
Minimal resistance of sensor set	Ω	80 for 10 V supply
	Ω	40 for 5 V supply
Max. cable length (to sensor)	m	30
Long term instability of output signal	%/month	$\leq 0,1$
Nonlinearity	%	$\leq 0,05$
Temperature gain coefficient	%/10°C	$\leq 0,05$
Temperature creep of output signal	%/10°C	$\leq 0,05$
Operating temperature	°C	$-25 \div +65$
Input Resistance	G Ω	symmetric ≥ 10
Asymmetric output: voltage	V	± 10 max.
output resistance	Ω	1
maximal current	mA	20
current	mA	0÷20 or 4÷20
maximal load resistance	Ω	500
Supply: voltage	V AC	230 / 50Hz
current – continuous use	A	0,1

*Parameter determined inside of amplifier regarding order and fixed by manufacturing without possibility to change.

Industrial amplifier CL 100P

Quality assurance

Each amplifier is examined internally before sale.
The manufacturer offers 36 month warranty and after market service.

Diameters:

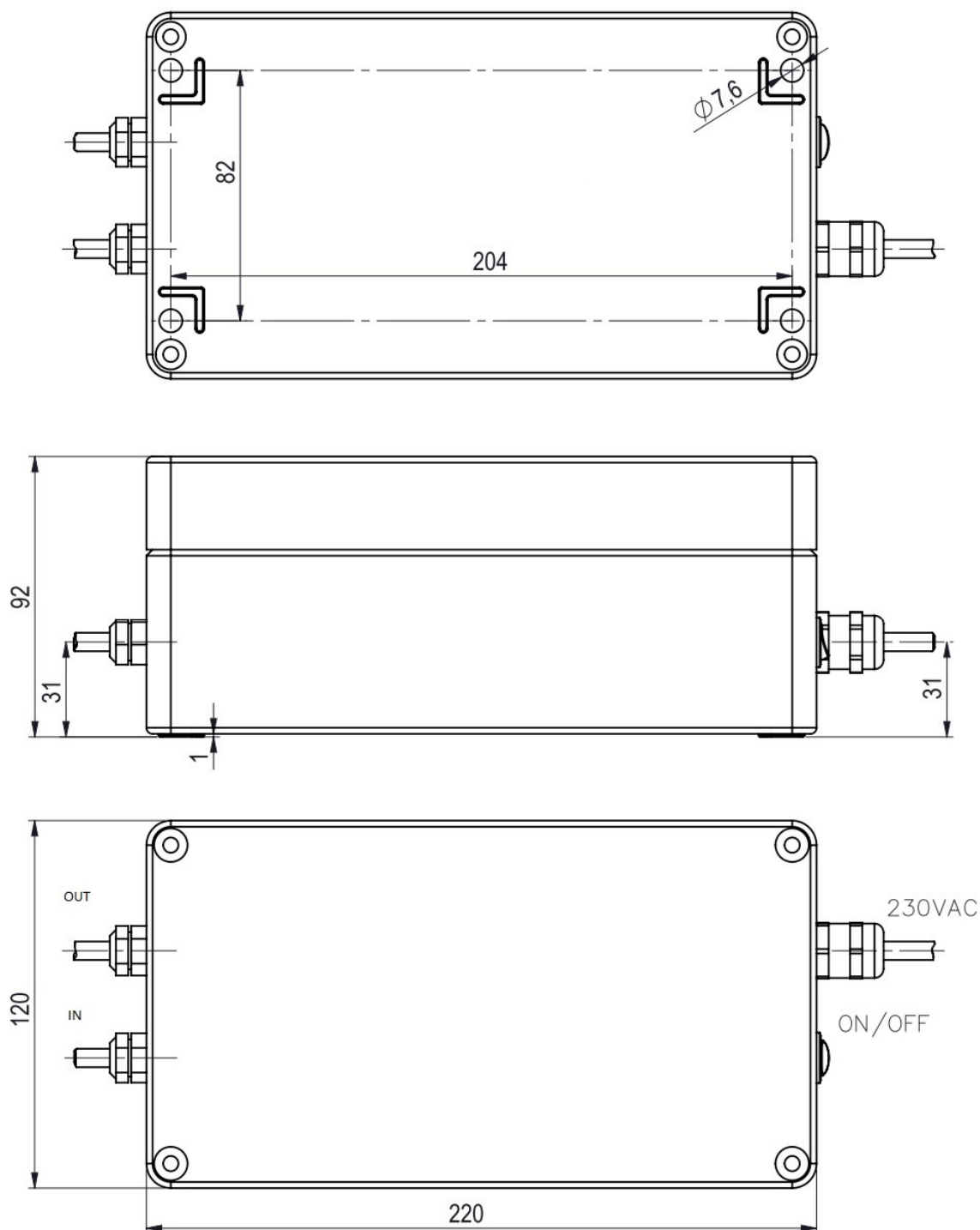

Manufacturer: _____

ZEPWN J. Czerwiński i Wspólnicy – sp.j., 05-270 Marki, ul. Kołtątaja 8, Poland
tel./fax: (4822) 7812169, 7712411, e-mail: zepwn@zepwn.com.pl, <http://www.zepwn.com.pl>